

 SHOP SIZE- 60 SQM/645 SQF



PASTRY SHOP



This concept is imagined with a **dual soul**: on one hand, it responds to **urban dynamism**, while on the other, it **offers a refuge** from the frantic pace, allowing guests to fully savor the delicacy of artisanal pastries.

The counter immediately captures the eye of anyone who enters. A **true stage** dedicated to haute patisserie, meticulously designed **to frame** and **enhance** every single **artisanal creation**.

Its aesthetic is an ode to **timeless elegance**: a wide, curved structure presented in a sophisticated **dusty blue** hue, enriched by profiled **geometric moldings**. Crowning this scenic vision, a luxurious **black marble** top creates a bold and captivating contrast, transforming every mignon, slice of cake, and baked good into a **precious jewel**. It is the exact point where haste disappears, leaving room only for visual beauty and the **pleasure of tasting**.





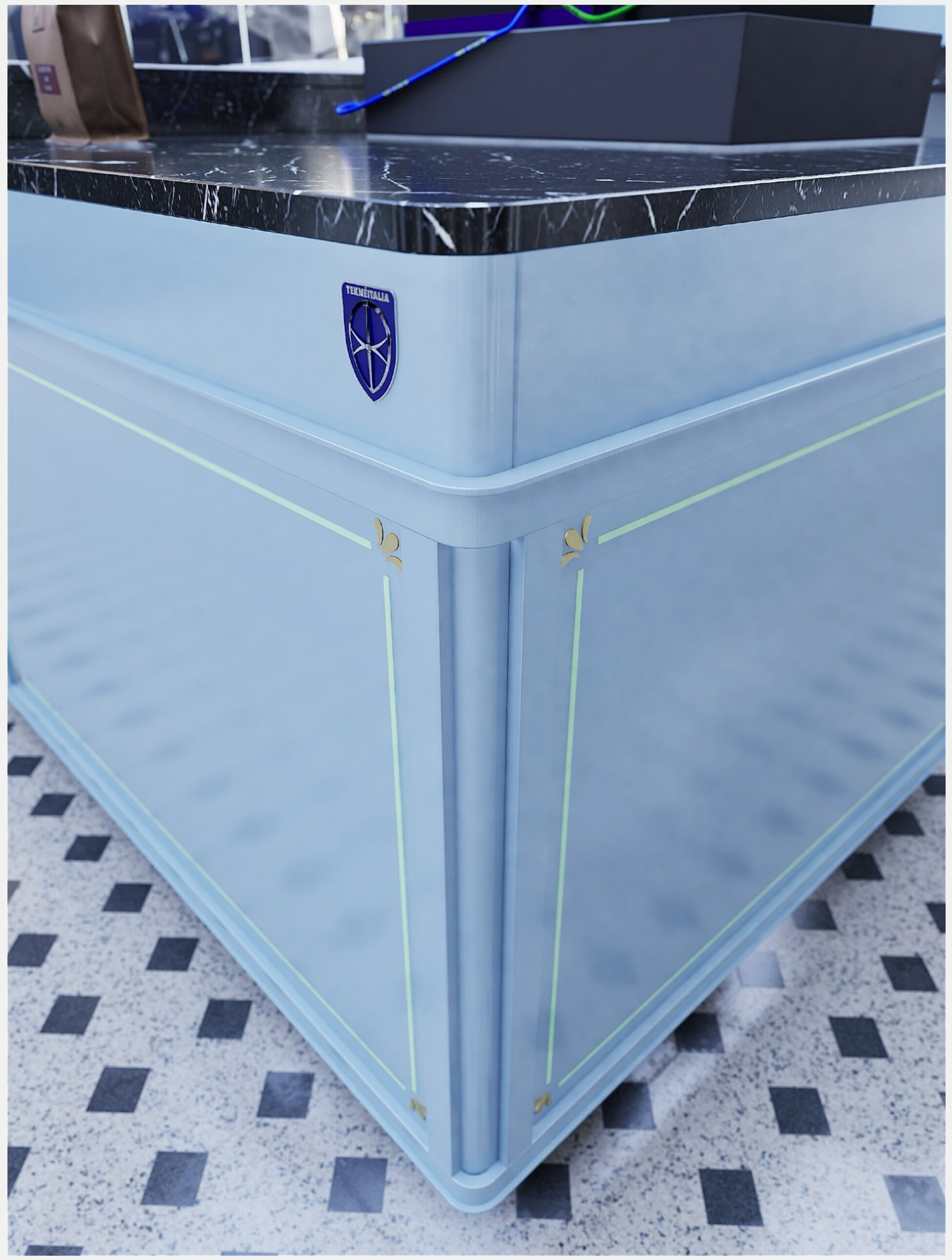
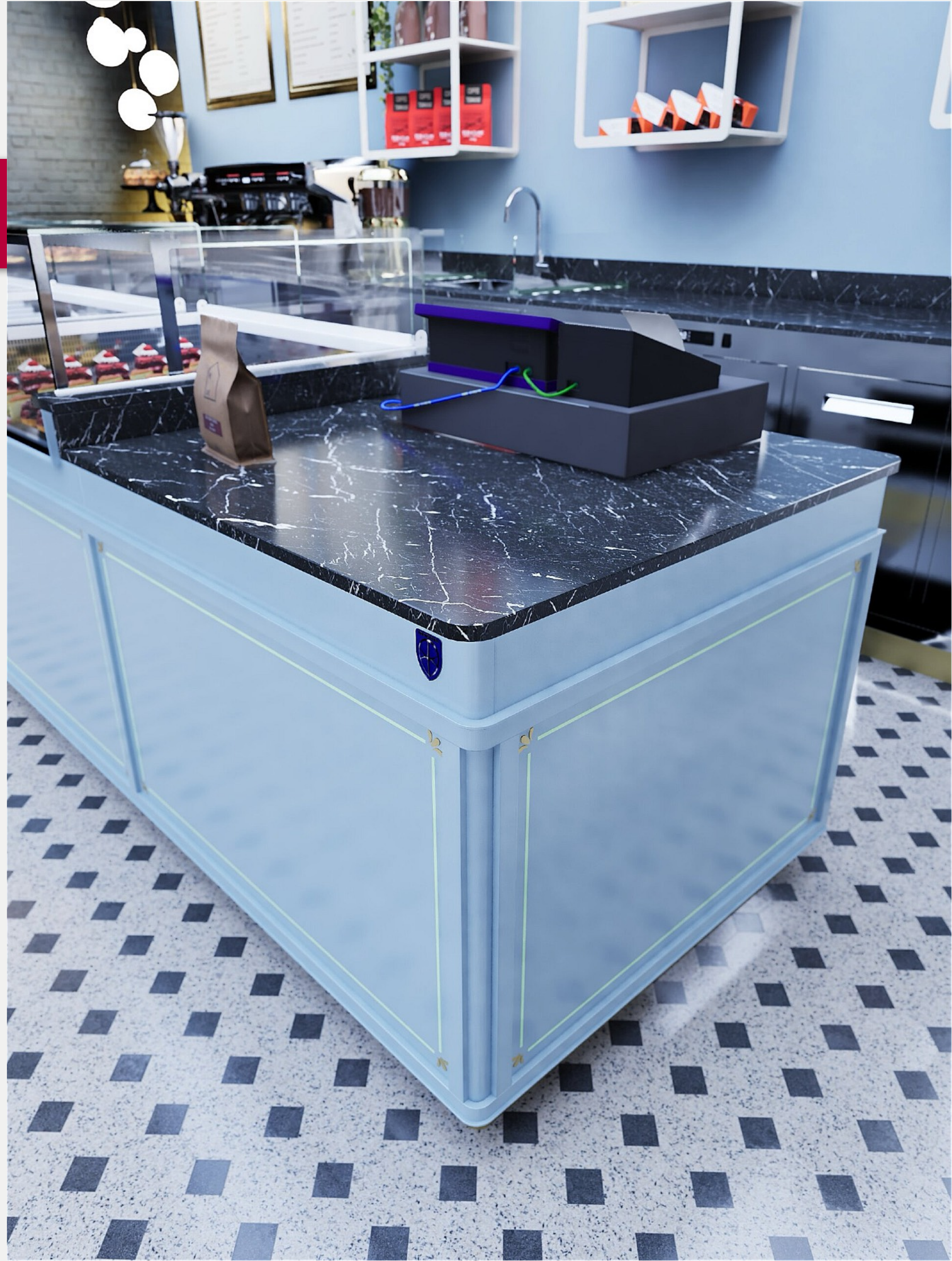































VIRTUAL TOUR

Discover our virtual environments: **explore in 3D the spaces designed for you**, experience immersive engagement, and make confident decisions. **Find the right inspiration** to create a tailor-made, innovative, and unique venue.



Virtual Tour



MOODBOARD

The space exudes a feeling of great brightness, cleanliness, and a refined, welcoming atmosphere. The design skillfully combines **classic-inspired** lines with **modern details**, creating a sophisticated, fresh, and inviting environment. The absolute standout color is a soft and soothing powder blue, applied to the walls and the structure of the imposing curved counter. This delicate tone is embellished and warmed by luminous brass and gold details, visible in the baseboards, the paneled moldings, and the frames of the wall-mounted menus. The polished black marble chosen for the countertops offers a bold and luxurious contrast, which dialogues perfectly with the geometric rigor of the black and white checkerboard floor. Completing the scene are lightweight structures that do not visually weigh down the space. The white arched shelving displays the products with great delicacy and recalls classic shapes, while the suspended white globe chandeliers diffuse a soft light that enhances the pastel colors. Finally, the white-painted exposed brick wall on the right adds a subtle textural touch that gives depth to the entire room.



PANTONE®
5425 U





FLOOR PLAN

The undisputed protagonist of this refined space is the majestic counter, an imposing design structure that immediately catches the eye of anyone who enters. This central element is not merely a service surface, but a true stage dedicated to haute patisserie, custom-designed to frame and enhance every single artisanal creation.

Its soft and sinuous line, which sweeps through the room accompanying the customer with its elegant curvature, is entirely clad in a sophisticated shade of dusty blue. This delicate hue is strongly enhanced by the rigorous geometric moldings and the baseboard, both outlined in a luminous gold that gives the structure a luxurious retro charm. Creating a sharp and deep contrast is the countertop, crafted from a magnificent dark material, akin to polished black marble, which elegantly reflects the ambient lighting.

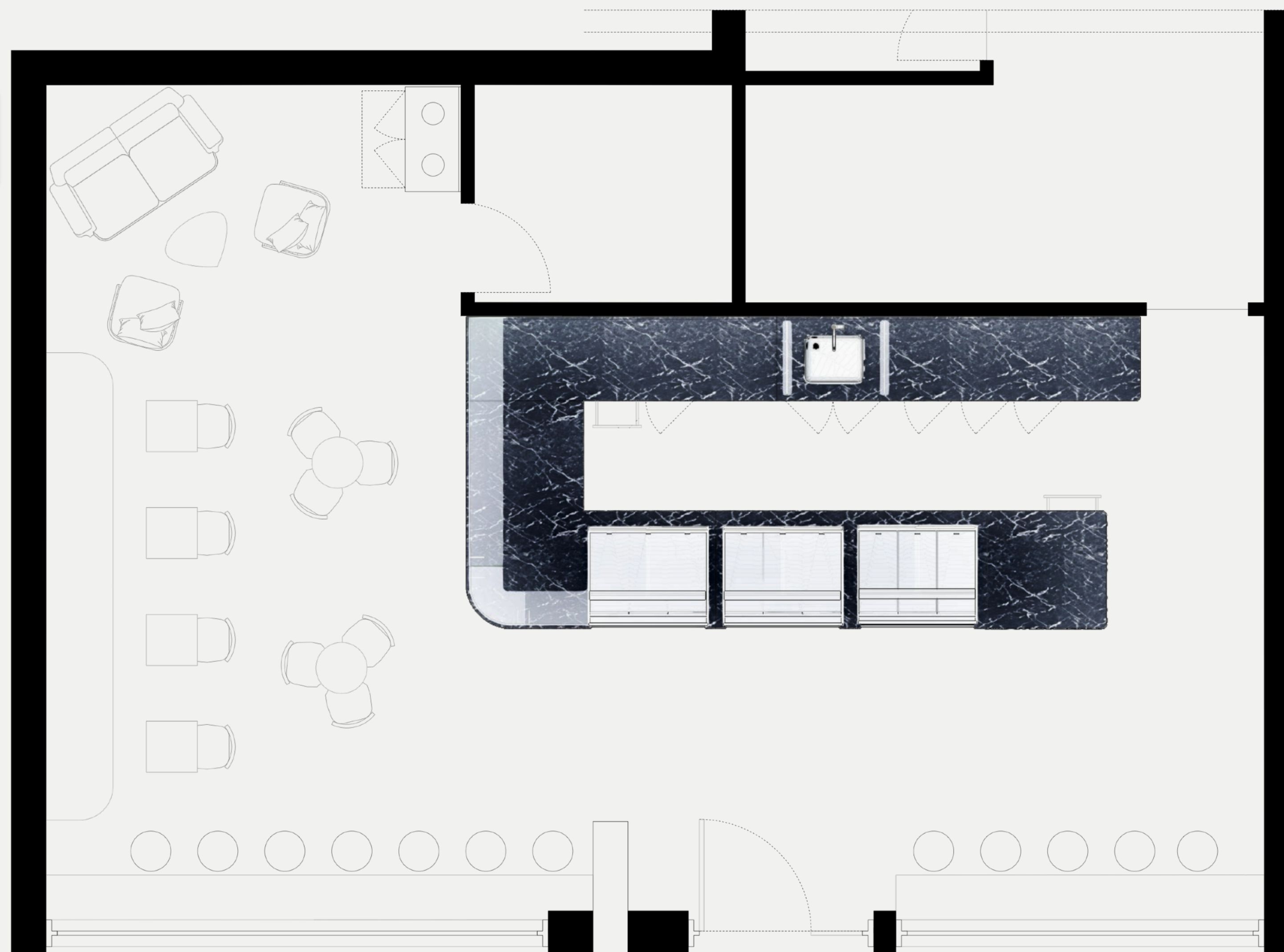



LAY-OUT

Beyond its aesthetic appeal, the venue's layout has been carefully designed to ensure a smooth and dynamic workflow. Customers immediately spot the checkout counter, strategically placed next to the three large pastry display cases. The design choice is to instantly highlight the sweet creations, declaring at first glance that haute patisserie is the true beating heart of the project. Moving further in, the large curve of the counter opens up spectacularly through wide glass surfaces, specifically designed to offer seated guests a privileged view of the extensive selection of breakfast and lunch items. This naturally defines a welcoming and distinct area for those who wish to pause and linger. To complete the picture, there is the back counter dedicated to the coffee station: strategically positioned, it ensures that even the act of preparing coffee becomes a true, visible ritual. This way, those comfortably seated at the tables can watch the fascinating gestures of the baristas, transforming a simple coffee break into a fully engaging, all-around sensory experience.

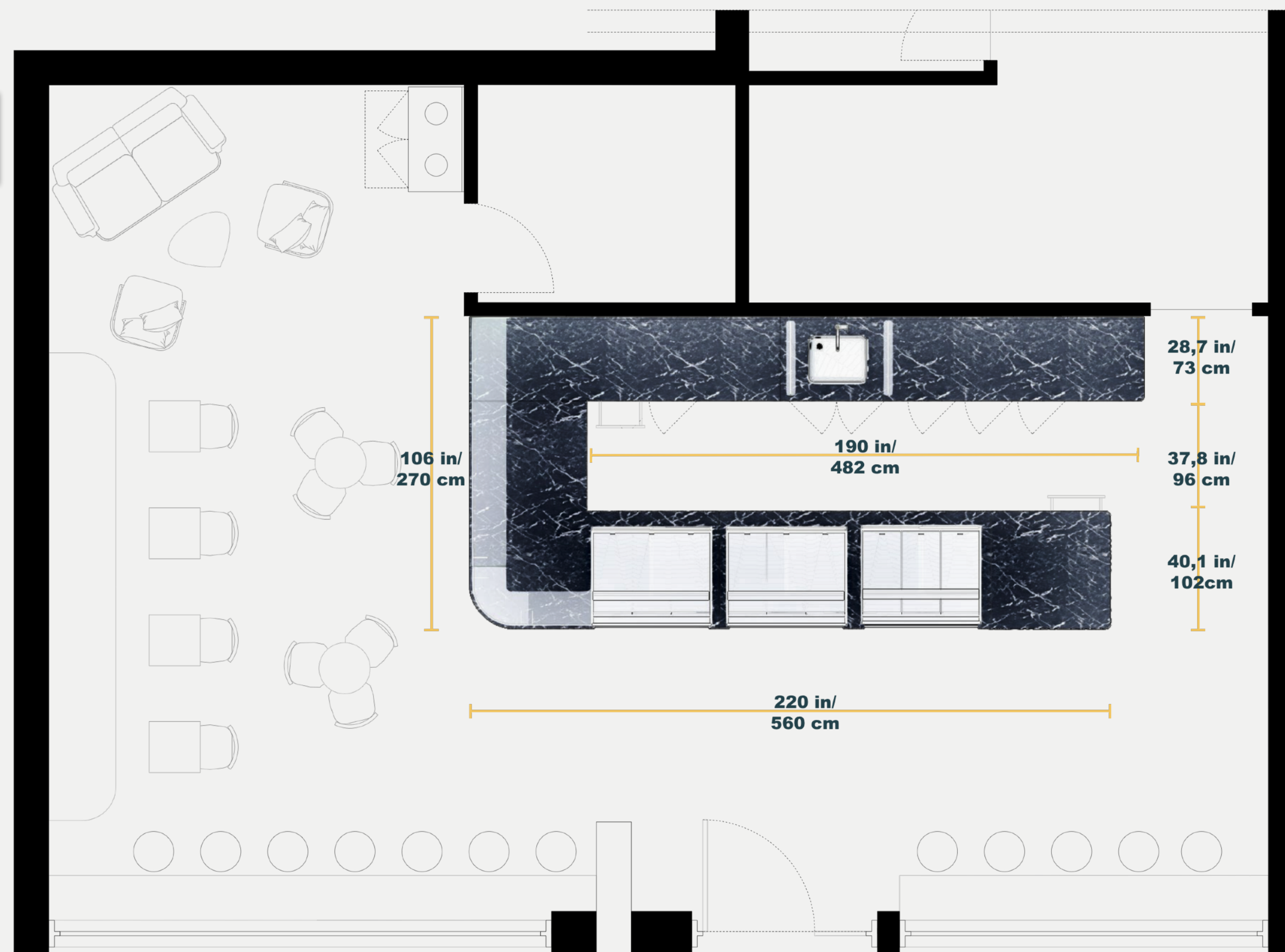



FURNITURE LIST

Furniture list - front counters:

- 1-Checkout counter
- 2-Refrigerated Pastry Display case
- 3-Refrigerated Pastry Display case
- 4-Refrigerated Pastry Display case
- 5-Front counter corner
- 6-Counter Two doors refrigerated

Furniture list - back counters:

- 7-Back Coffee counter Coffee machine
- 8-Glass washer cabinet
- 9-Back counter sink
- 10-Back counter Three doors refrigerated
- 11- Bin Cabinet

1 - CHECKOUT COUNTER

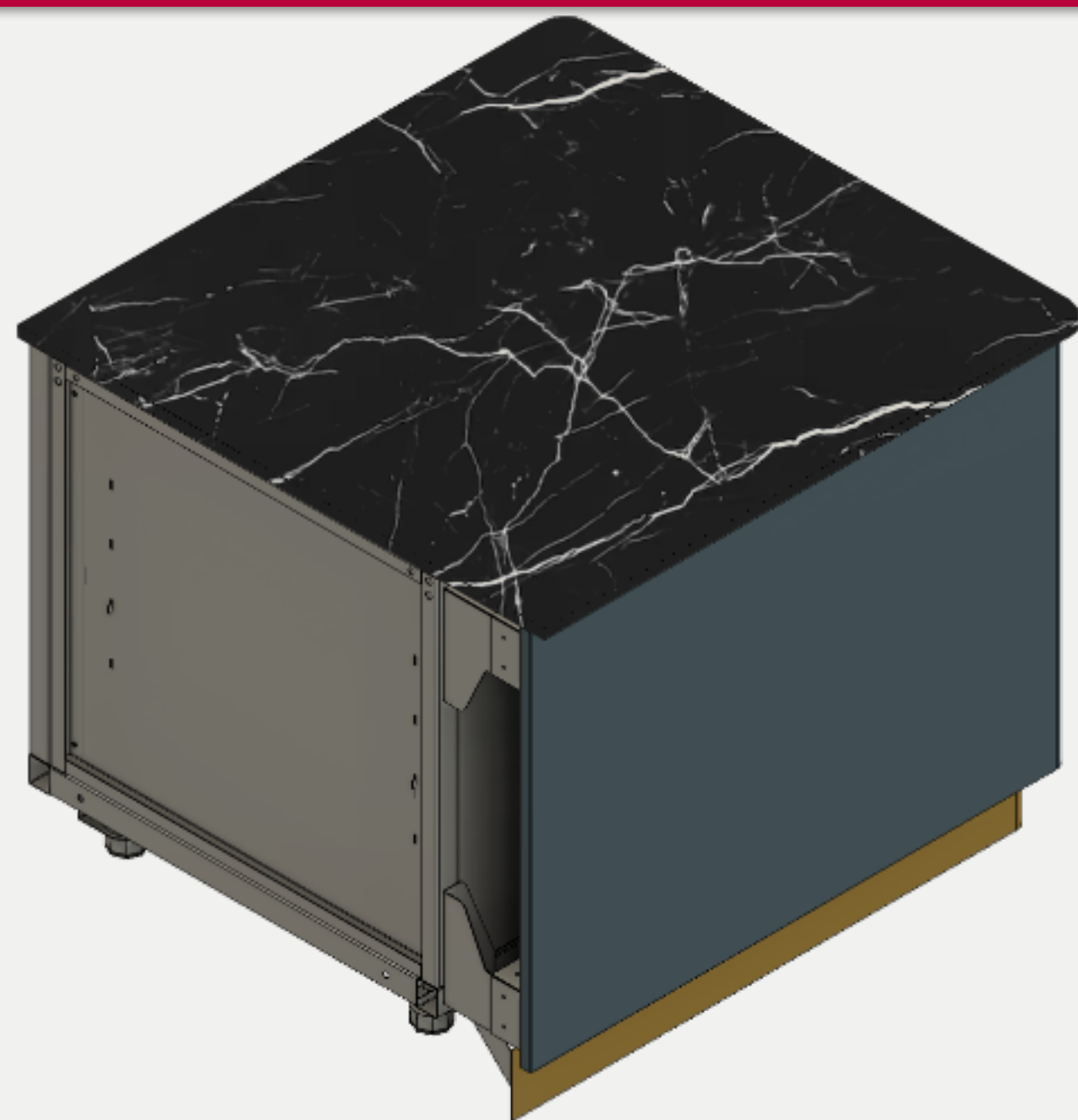

- Stainless steel frame
- 2 Stainless steel drawer
- 1 Stainless steel shelves
- Front panels made galvanized steel
- Plinth coated made galvanized steel

The checkout counter, with a **fully stainless steel frame**, is designed to ensure efficiency and organization in any operational setting. Equipped with **large stainless steel drawers and shelf**, it offers a durable, hygienic, and functional solution for space management. The Silestone® Cosentino surface guarantees long-lasting performance and easy cleaning, while the **front panels**, made of powder-coated galvanized steel with **high-resistance finishes**, complete the structure by combining strength with essential aesthetics.

Checkout counter top in Silestone®

Dim: **W**x**L**x**H**

inch: **40,1** x **40,9** x **33,8**

cm: **104** x **104** x **86**

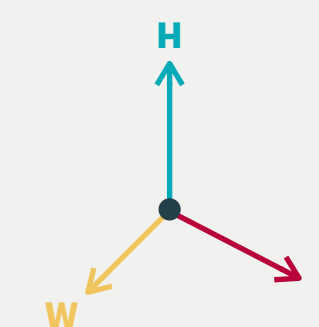

 2/3/4 - REFRIGERATED PASTRY DISPLAY CASE

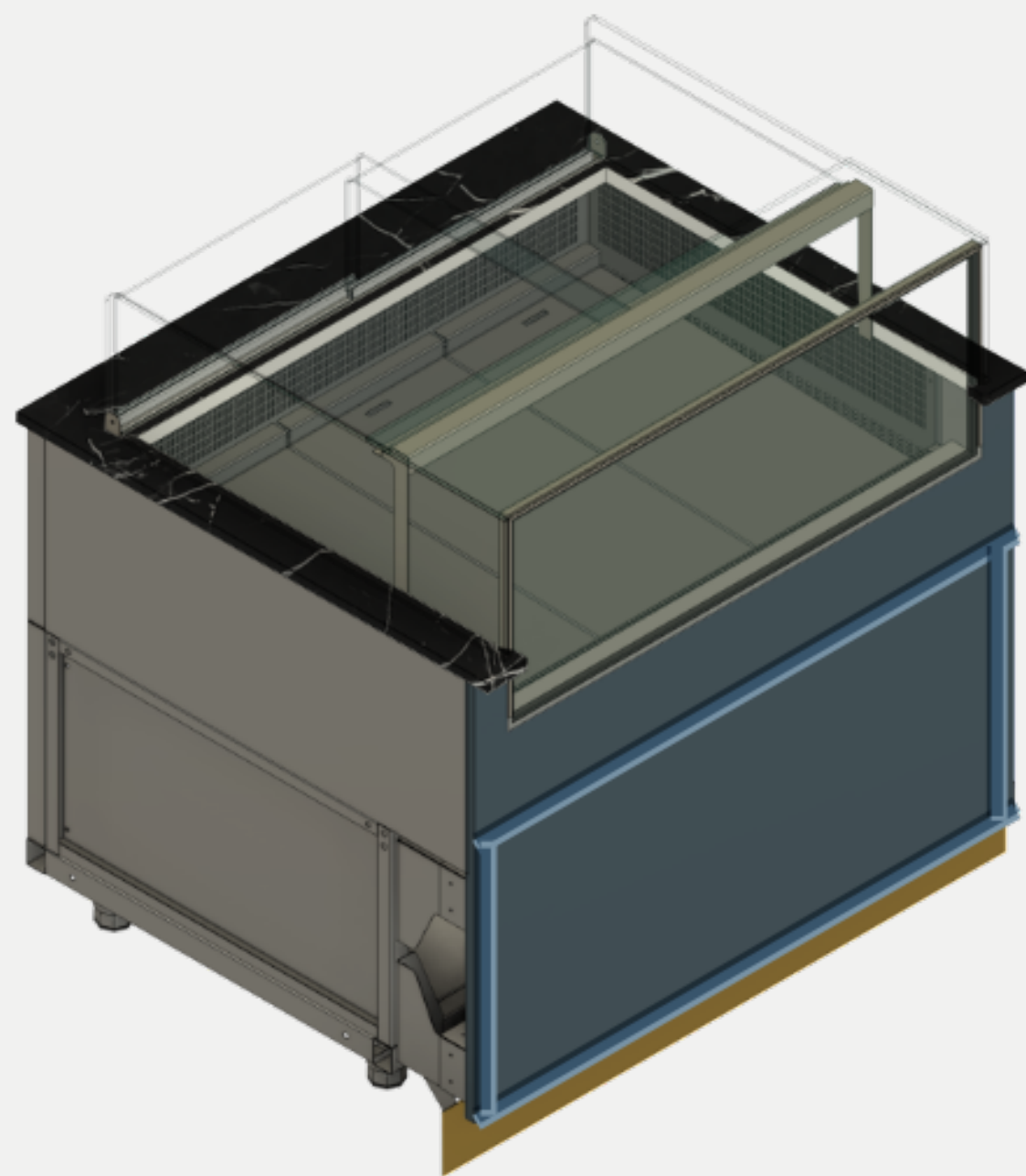

- Stainless steel frame
- 1 Stainless steel drawer
- heated double front glass
- Front panels made galvanized steel
- Plinth coated made galvanized steel
- compressor unit

Pastry display case integrated into the furniture, entirely made of stainless steel.

The heated double-glass front prevents fogging, ensuring maximum product visibility at all times. Designed with a strong focus on ergonomics, it offers customers an optimal view of the gelato while providing the operator with practicality and comfort in daily use.

It features a **professional control system** for precise temperature management and **integrated refrigeration units**. The **Silestone® Cosentino** surface guarantees durability and easy cleaning, while the front panels in **painted galvanized steel** with high-resistance finishes complete the structure, combining robustness with essential aesthetics.

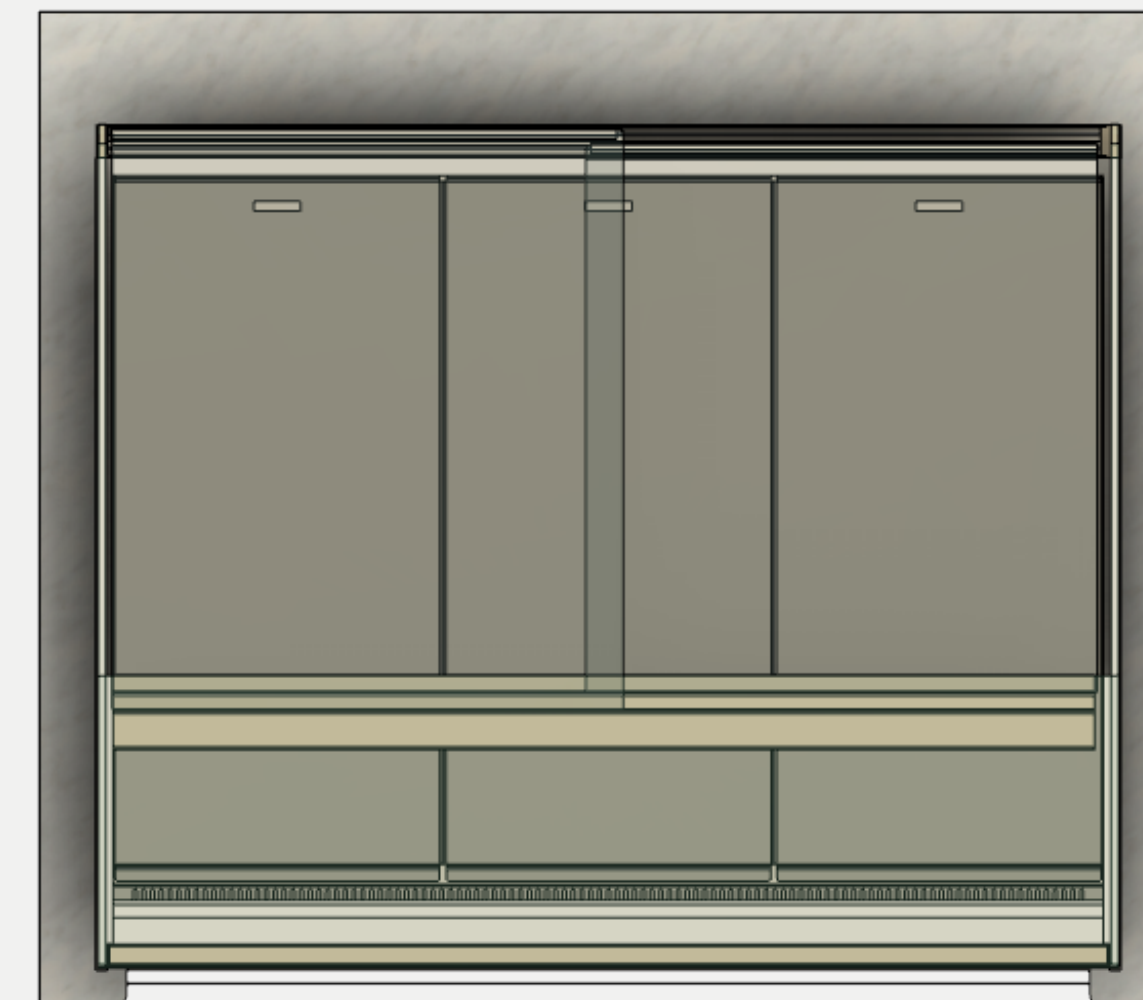

Pozzetti counter top in Silestone®

Dim: **W**x**L**x**H**
inch: **40,1** x **47,2** x **37**
cm: **102** x **120** x **94**

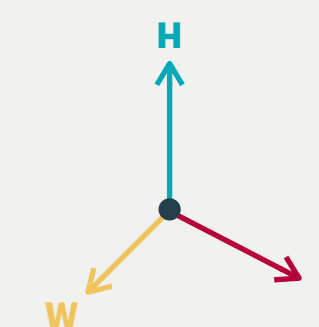

5 - FRONT COUNTER CORNER

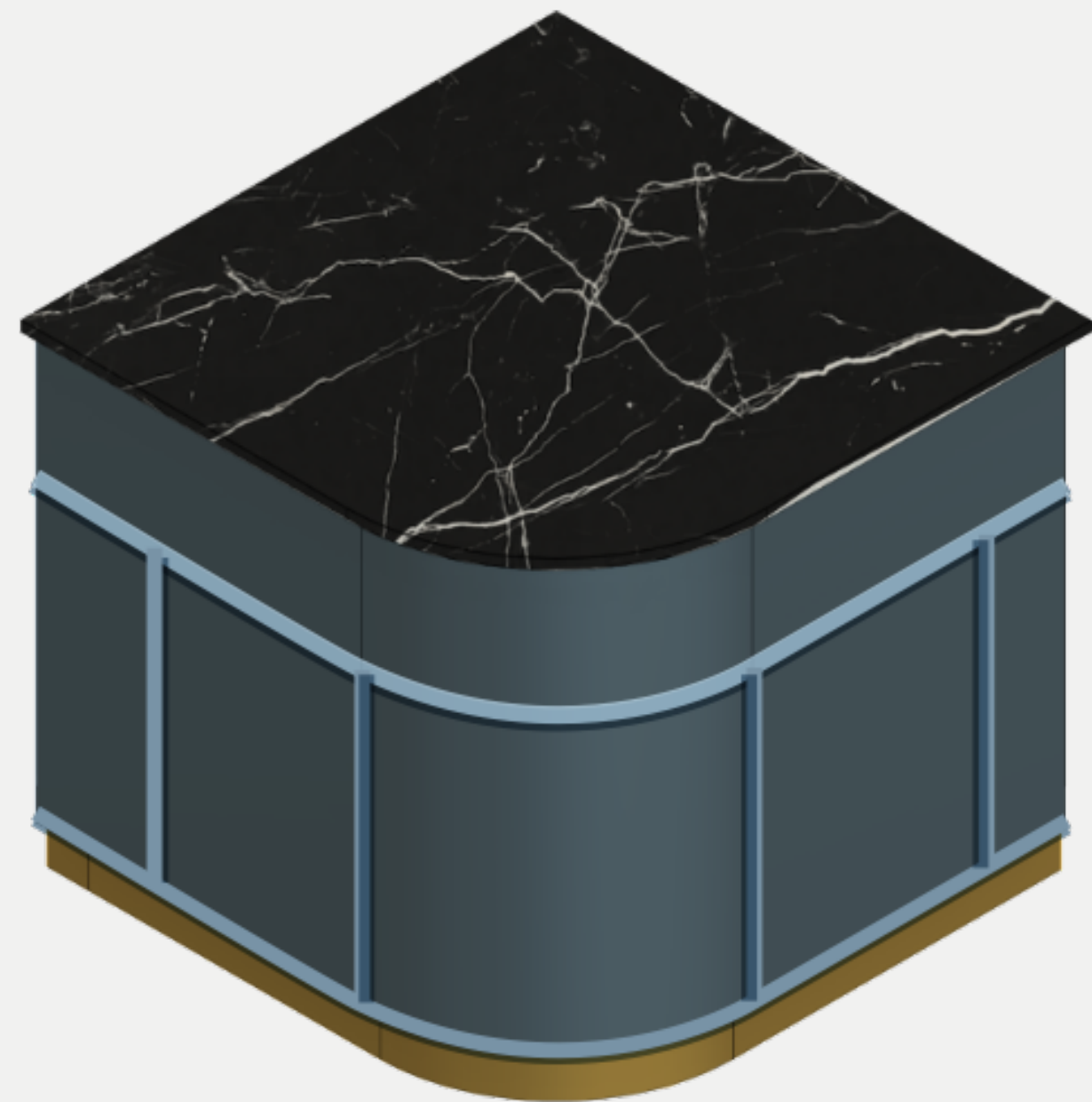

- Stainless steel frame
- Front panels made galvanized steel
- Plinth coated made galvanized steel

The Front counter corner, with a **fully stainless steel frame**, is designed to ensure efficiency and organization in any operational setting. The Silestone® Cosentino surface guarantees long-lasting performance and easy cleaning, while the **front panels**, made of powder-coated galvanized steel with **high-resistance finishes**, complete the structure by combining strength with essential aesthetics.

Pozzetti counter top in Silestone®

Dim: **W**x**L**x**H**

inch: **40,1** x **40,1** x **37**

cm: **102** x **102** x **94**

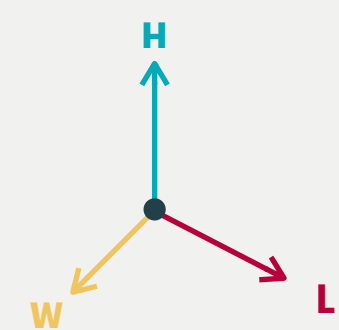

 **6- COUNTER TWO DOORS REFRIGERATED**



- Stainless steel frame
- 2 Doors refrigerated cabinet
- compressor unit
- Plinth coated made galvanized steel

The refrigerated cell, with a fully stainless steel structure, is designed to ensure maximum hygiene, durability, and reliability. Equipped with an **on-board refrigeration unit**, it provides precise temperature control in all operating conditions. The **Silestone® Cosentino** surface completes the system, offering high durability and easy cleaning.

Pozzetti counter top in Silestone®

Dim: **W**x**L**x**H**

inch: **40,1** x **67** x **37**

cm: **102** x **170** x **94**

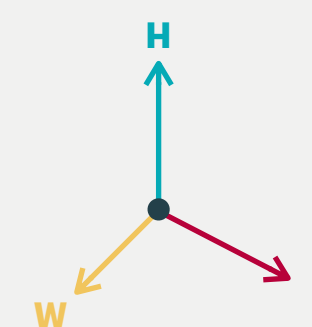

7 - BACK COUNTER COFFEE MACHINE



- Stainless steel frame
- 1 Stainless steel Cabinet doors
- 2 coffee drawer
- 2 Stainless steel shelves
- Plinth coated made galvanized steel

The coffee machine back counter, made entirely of stainless steel with a stainless steel door, is designed to ensure durability, hygiene, and everyday practicality. Equipped with **two hoppers for coffee preparation**, it offers an efficient and functional solution for industry professionals. The **Silestone® Cosentino** surfaces ensure long-lasting performance, easy cleaning, and a refined look—ideal even for areas visible to customers.

Pozzetti counter top in Silestone®

Dim: **W**x**L**x**H**

inch: **28,7** x **37,8** x **37**

cm: **73** x **96** x **94**

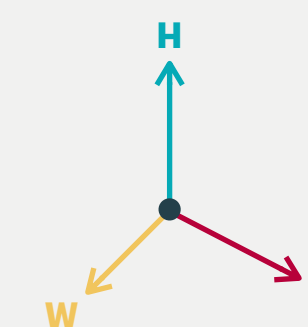

8 - GLASS WASHER CABINET



- Stainless steel frame
- 1 Stainless steel shelves
- Plinth coated made galvanized steel

The checkout counter, with a **fully stainless steel frame**, is designed to ensure efficiency and organization in any operational setting. Equipped with **large stainless steel shelf**, it offers a durable, hygienic, and functional solution for space management. The Silestone® Cosentino surface guarantees long-lasting performance and easy cleaning, while the **front panels**, made of powder-coated galvanized steel with **high-resistance finishes**, complete the structure by combining strength with essential aesthetics.

Pozzetti counter top in Silestone®

Dim: **W**x**L**x**H**

inch: **28,7** x **28,3** x **37**

cm: **73** x **72** x **94**

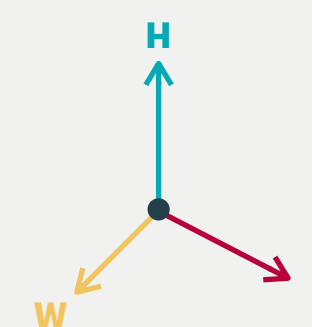



9 - BACK COUNTER SINK



- Stainless steel frame
- 2 Stainless steel Cabinet doors
- Stainless steel sink and tap
- 2 Stainless steel doors
- Plinth coated made galvanized steel

The professional **sink unit**, with a **fully stainless steel frame and doors**, is designed to ensure durability and functionality in demanding work environments. Equipped with a **large sink** and **professional faucet**, it combines practicality and ease of use while remaining **elegant and visually appealing to the public**. The Silestone® Cosentino surface guarantees durability and easy cleaning

Pozzetti counter top in Silestone®

Dim: **W**x**L**x**H**

inch: **28,7** x **39,3** x **37**

cm: **73** x **100** x **94**

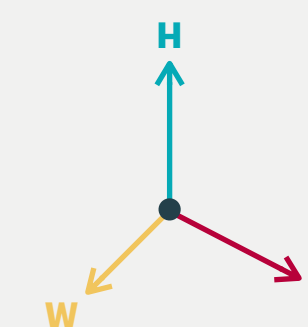

 10 - BACK COUNTER 3 DOORS REFRIGERATED

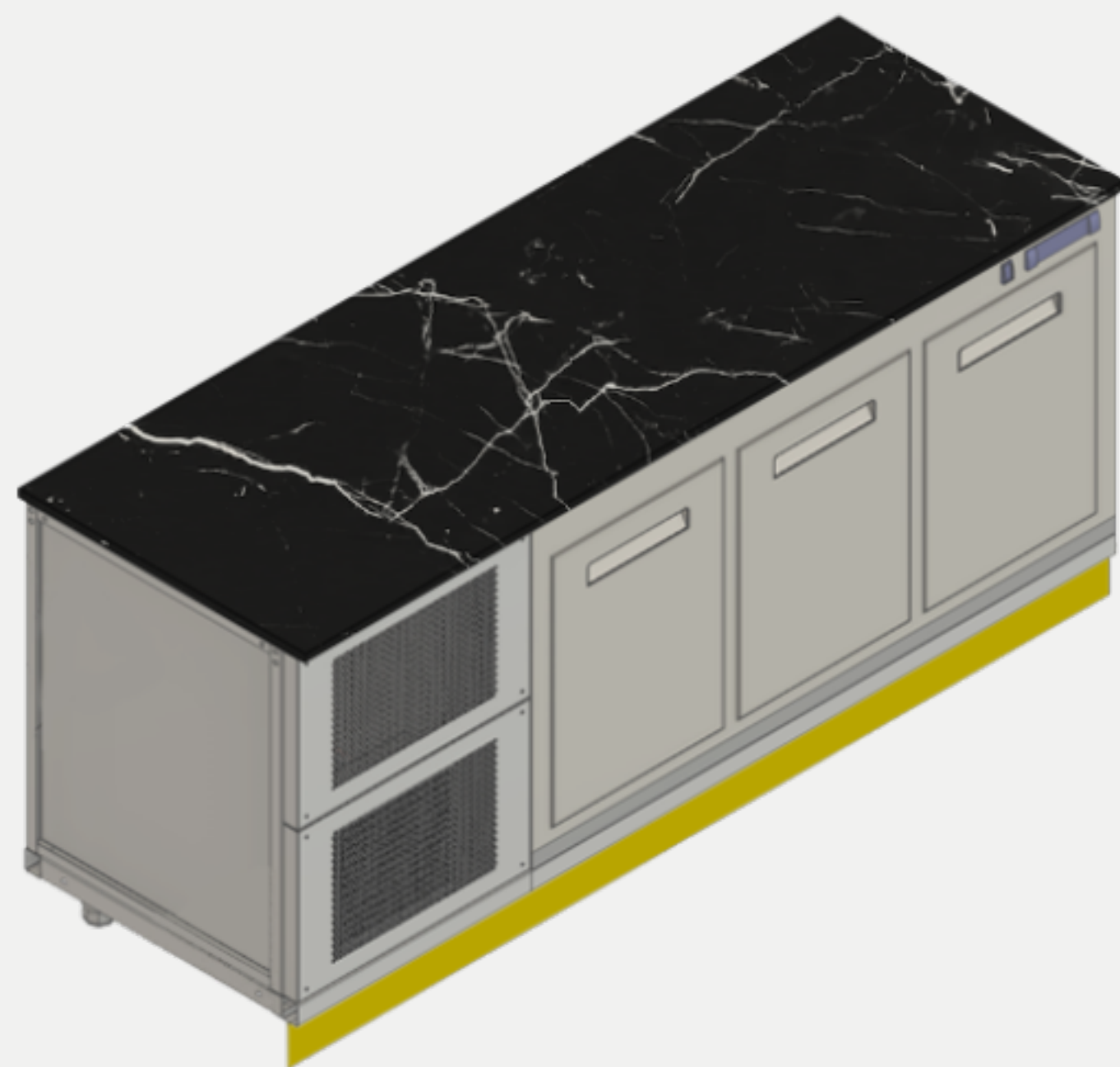

- Stainless steel frame
- 3 Doors refrigerated cabinet
- compressor unit
- Plinth coated made galvanized steel

The refrigerated cell, with a fully stainless steel structure, is designed to ensure maximum hygiene, durability, and reliability. Equipped with an **on-board refrigeration unit**, it provides precise temperature control in all operating conditions. The **Silestone[®] Cosentino** surface completes the system, offering high durability and easy cleaning.

Pozzetti counter top in Silestone[®]

Dim: **W**x**L**x**H**

inch: **28,7** x **82,6** x **37**

cm: **73** x **210** x **94**

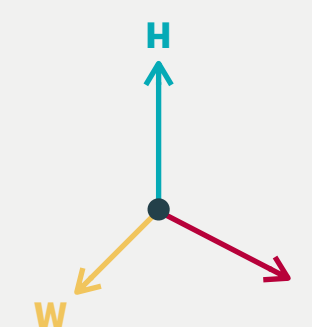



11-BIN CABINET

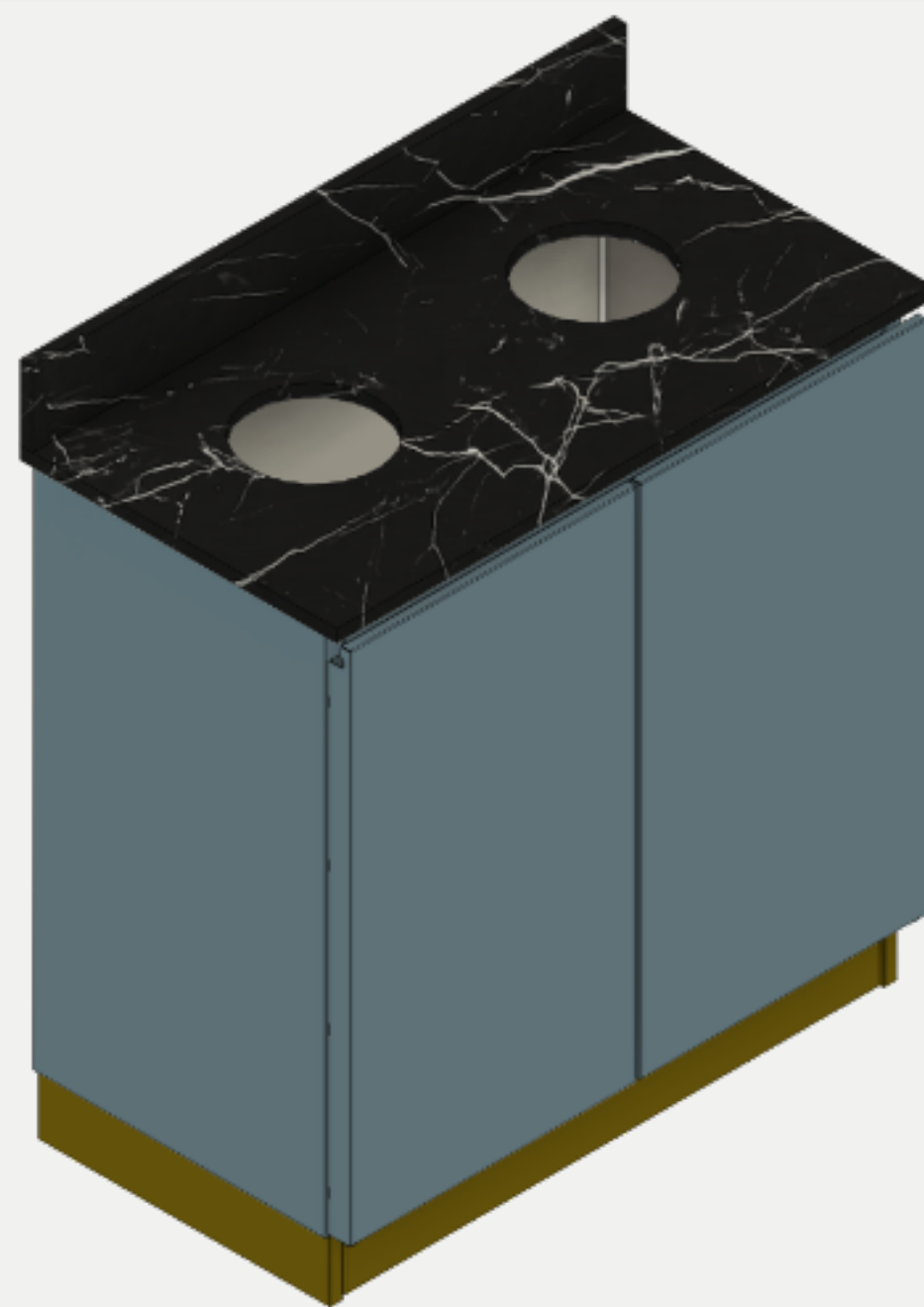

- Stainless steel frame
- 2 coated Doors made galvanized steel
- Plinth coated made galvanized steel

The bin cabinet, with a **fully stainless steel frame**, is designed to ensure efficiency and organization in any operational setting. Equipped with 2 coated doors, it offers a durable, hygienic, and functional solution for space management. The Silestone® Cosentino surface guarantees long-lasting performance and easy cleaning, while the **front panels**, made of powder-coated galvanized steel with **high-resistance finishes**, complete the structure by combining strength with essential aesthetics.

Pozzetti counter top in Silestone®

Dim: **W**x**L**x**H**

inch: **36,6** x **19,7** x **37**

cm: **93** x **50** x **94**

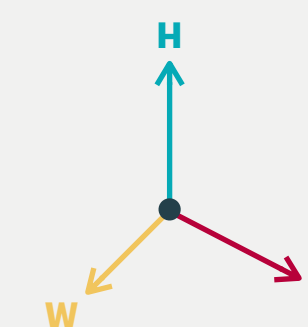



SPLASH GUARD

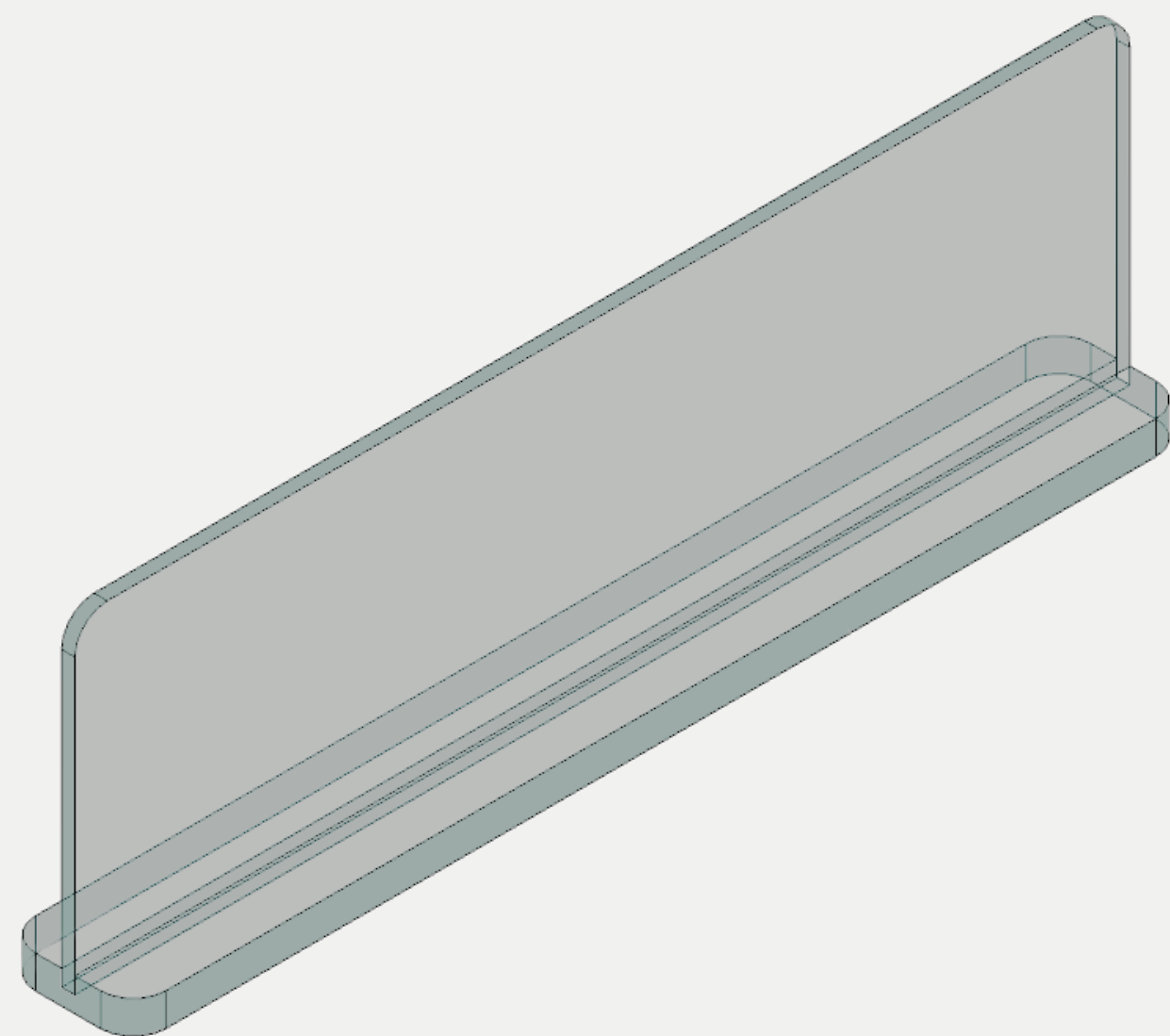

-N2 Splash Guard

Transparent polycarbonate splash guard

Provides safe protection while keeping the work area clean, without compromising the aesthetic of the space thanks to its transparency and discreet design.

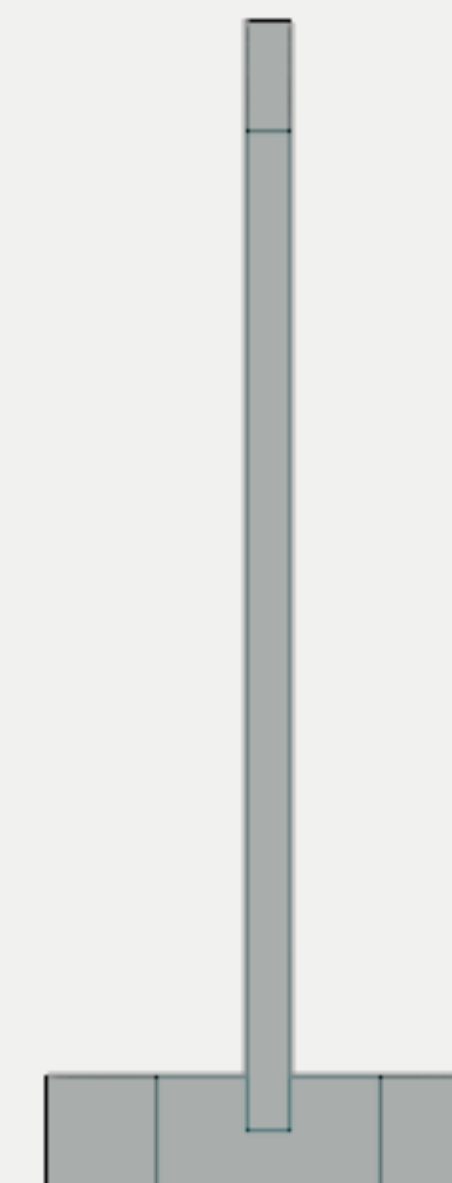

Polycarbonate

Dim: **W**x**L**x**H**

inch: **27,5** x **4,7** x **8,7**

cm: **70** x **12** x **22**

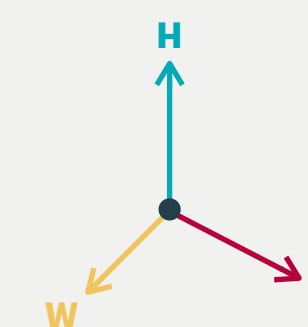



I RIVESTIMENTI: I PIANI

silestone®

By COSENTINO®

A leading brand for over 30 years that inspires designs for kitchens, bathrooms and commerciale surfaces.

25 Years warranty
Hybrid mineral surfaces to create innovative spaces that endure over the time.

Advantages and properties



Elevata resistenza ai graffi
l'uso e l'usura quotidiana non graffiano Silestone.

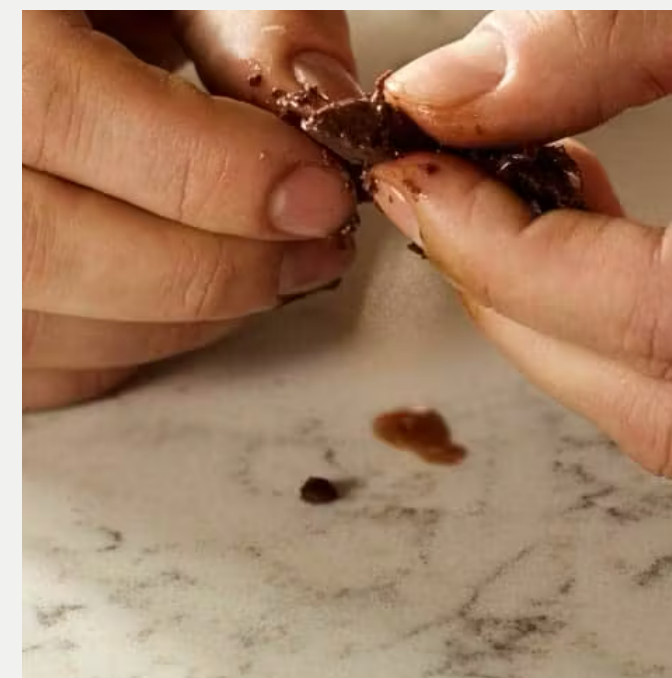

Elevata resistenza alle macchie
La bassa porosità li rende altamente resistenti alle macchie.



Alta resistenza agli urti
Altamente resistente agli impatti quotidiani.

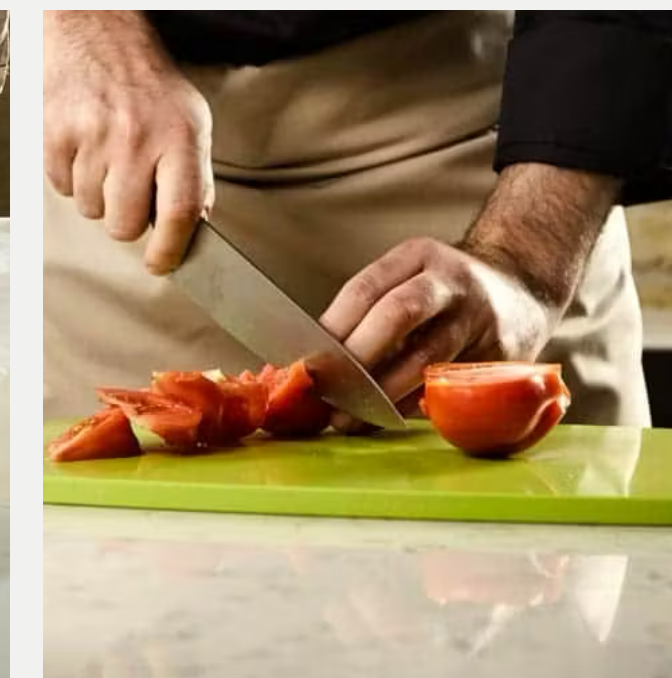

Elevata resistenza agli acidi
La bassa porosità gli impedisce di essere danneggiato da macchie aggressive.

Finish



Polished
More vibrant and intense colors and reflections

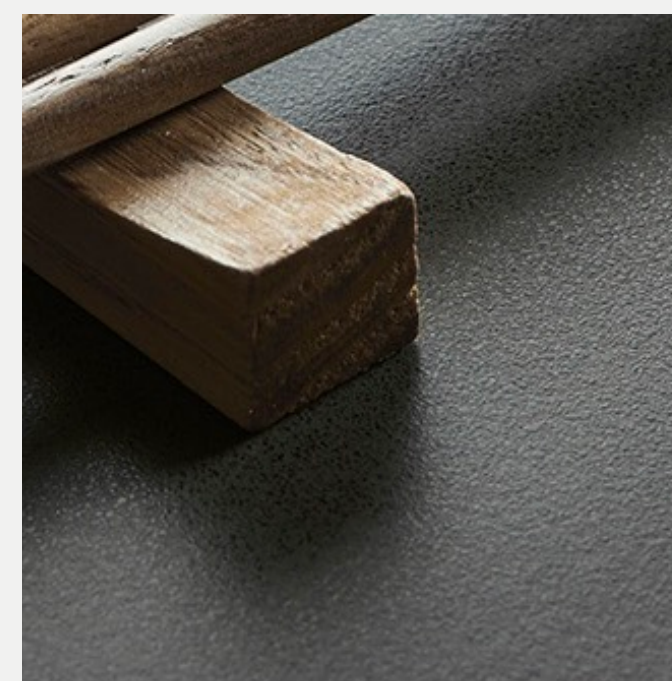

Suede
Soft and pleasant feel with full color consistency

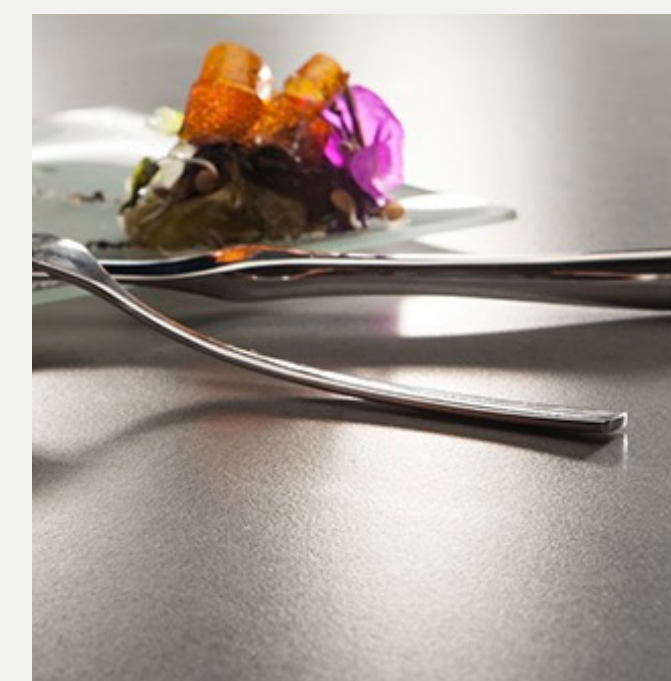

Mate
Solid and satin color

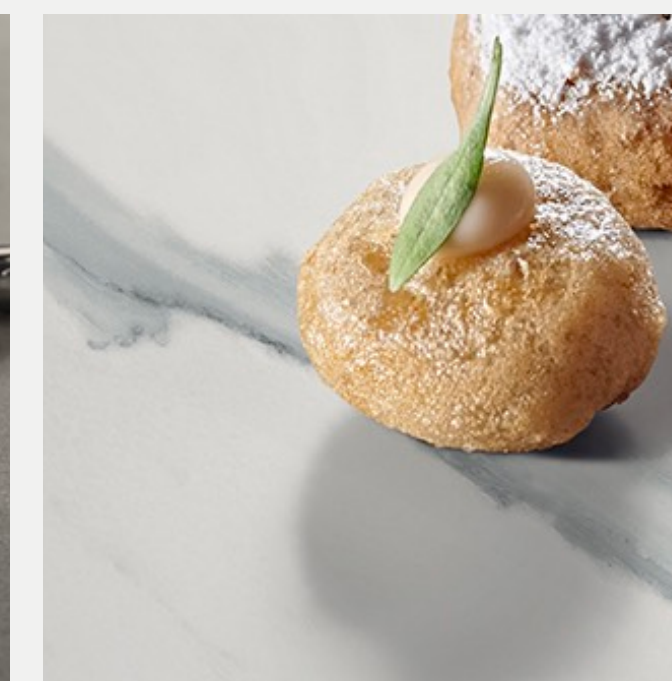

Velvet

Maintenance



Click the colors to see them in use

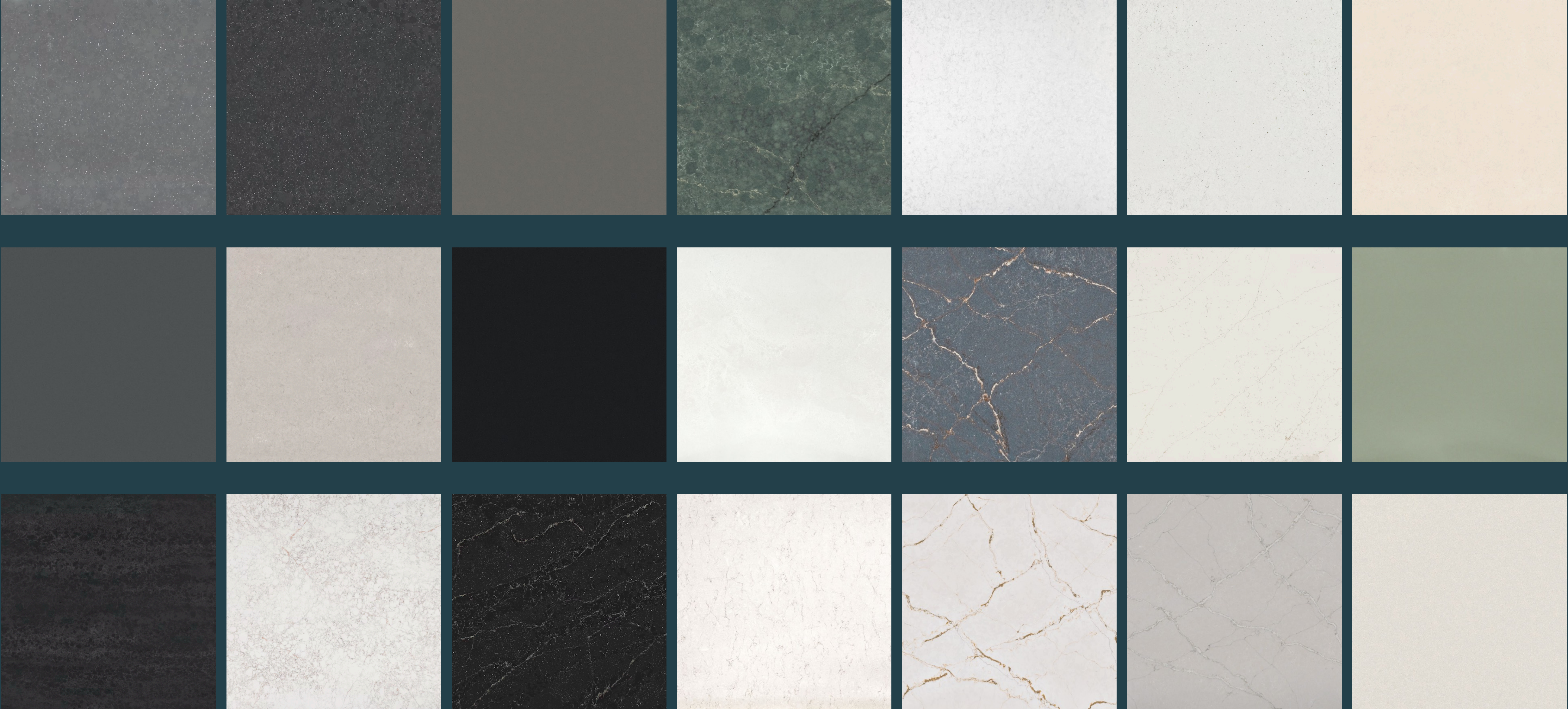

 **COLORS WITHOUT LIMITS**



[RAL Chart](#)

PANTONE®

[Pantone Chart](#)

kerakoll

[Kerakoll Chart](#)

With TekneItalia, you're never confined to a preset color palette. **We offer access to thousands of colors** through internationally recognized systems like **RAL** and **PANTONE***, ensuring your customization is truly **limitless**. Whatever shade you envision, we can bring it to life—without compromises and without boundaries.

 **COLORS WITHOUT LIMITS**

3M

DI-NOC™

3M™ DI-NOC™ Architectural E-Series PO Polyolefin Film are film surface finishes that give you a range of choices as you pursue your sustainability goals. These films are made with approximately 99.5% non-PVC (non-vinyl) materials, and do not contain more than 0.5% of a polyvinyl chloride-based component. **These finishes are available in various patterns and textures – wood, plaster, concrete and more, and are a great way to upgrade your interior look without all the disruption.** 3M™ Comply™ Adhesive technology virtually eliminates air bubbles, simplifying and speeding up the application process.



Catalogue 3M Di - NOC



TOTAL CUSTOMIZATION

With TekneItalia, every piece of furniture becomes a **unique expression of your brand**. **Integrated “under-surface” digital graphics, stencil techniques, and glossy or matte finishes are just some of the available options.** Thousands of combinations of materials, colors, and details allow you to create truly tailor-made solutions, with no limits to customization.





PROMINENT DETAILS

Laser-engraved details add depth and personality to the furniture, with the option to be painted or finished with an elegant 24-carat gold plating. **Custom-made**, these exclusive elements transform any space, making your venue unique and **instantly recognizable**.



THIS IS A **TEKNEITALIA**® PROJECT

Tekneitalia is a company founded **over 15 years ago** with the clear and ambitious goal of revolutionizing the way business is done in the HO.RE.CA. sector. Through **carts and mobile devices with iconic and highly recognizable design**, we have made **beauty a tool for work**. From day one, our mission has been to offer clients **not only functional tools but true extensions of their identity**: objects capable of expressing **values, emotions**, and visions through a refined and **timeless aesthetic**.

TEKNEITALIA®
Brows our website



TEKNEITALIA®



YOUR PROJECT, GUIDED BY EXPERT

A dedicated team of **architects and graphic designers** will support you at every stage of development, working closely with you to create the best version of your project. Thanks to 3D modeling in a virtual environment, you'll be able to explore every detail of your venue before implementation, choosing each element with precision and ensuring a flawless result.

Contact us and **share your needs** to discover how we can **turn your project into reality**. Receive detailed information and a personalized quote, with **no obligation**.

INFO@TEKNEITALIA.COM

MOBILE OFFICE: +39 328 221 34 74

MOBILE SALES EXPORT: + 39 366 421 23 63

TEKNEITALIA USA: +1 212 810 6725